

AI-1 Quickstart Guide

1 Connect AI-1 to computer via USB

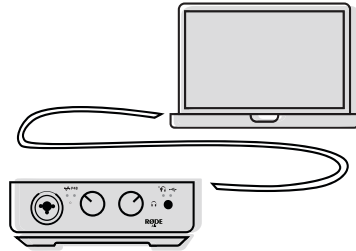

2 Connect microphone or instrument using an XLR or 1/4-inch cable (not included)

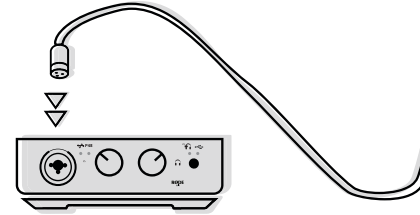

3 A Enable phantom power (P48) for condenser microphones
Press left knob and P48 light will illuminate red

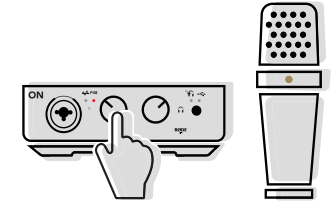

3 B Disable P48 for dynamic microphones
Press left knob again and P48 light will turn off

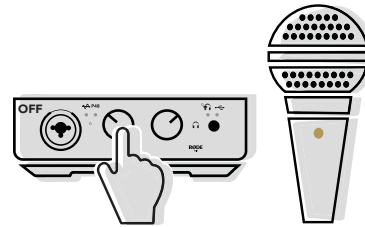

4 Set input level with left knob while checking signal light

A Green is good



B Turn down when Red

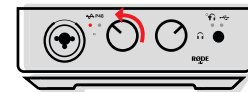

5 Connect headphones (not included) to 1/4-inch output, adjust volume with right knob



Love your AI-1?
Share with us [#rodemic](#)

@rodemic rodemic

@rodemics @rodemic

RØDE



6 Enable direct monitoring by pressing right knob

A ON - Signal goes from mic directly to headphones

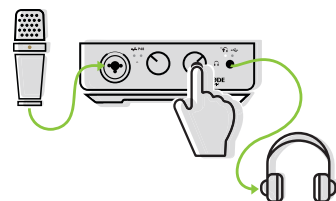

B OFF - Signal goes from mic through computer to headphones

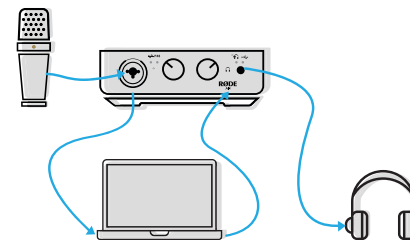

7 If using powered speakers, disconnect headphones to activate the balanced speaker outputs

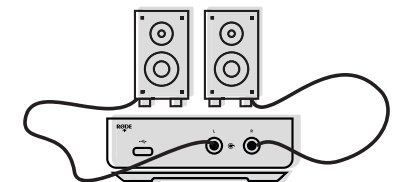

You're now ready to create!